



AUCTION

LEADING THE INDUSTRY SINCE 1945

MONDAY – JULY 9, 2018 – 5:30 PM

Attn: Hunters & Investors

**150+ ACRES VACANT LAND – SOLD IN ONE PARCEL
CRAWFORD CO., PA. – BEAVER TWP.**

Absolute auction, all sells to the highest bidders on location:

22062 SOUTH BEAVER RD., CONNEAUTVILLE, PA 16406

Directions: Take Rt. 167 east of Ohio into PA and Rt. 198 and continue east to S. Beaver Rd. and north – or – Rt. 198 west of Rt. 18 in Conneautville, PA to S. Beaver Rd. Watch for KIKO signs.

Approx. 12 acres open farmland in front – all wooded in rear – heavy timber has been cut. Great hunting area. Come walk it over – call for map or visit us on the web. For questions on financing or terms call Rusty.

TERMS ON REAL ESTATE: 10% down auction day, balance due at closing. A 10% buyer's premium will be added to the highest bid to establish the purchase price, which goes to the seller. Any desired inspections must be made prior to bidding. All information contained herein was derived from sources believed to be correct. Information is believed to be accurate but not guaranteed.

Auctioneer/Realtor:

Russell T. (Rusty) Kiko, Jr., C.A.I., ext 115, 330-495-0923, #AU-002727L & RS-222810-L.
Russ Kiko Assoc. #AY000170L.



Information is believed to be accurate but not guaranteed.



330.455.9357 • kikoauctions.com





KIKO AUCTIONEERS

2722 Fulton Dr. NW, Canton, OH 44718
kikoauctions.com

MONDAY – JULY 9, 2018 – 5:30 PM

150+ ACRES VACANT LAND

Attn: Hunters & Investors
Sold In One Parcel
Crawford Co., PA. – Beaver Twp.



Members – State and National Auctioneers Association

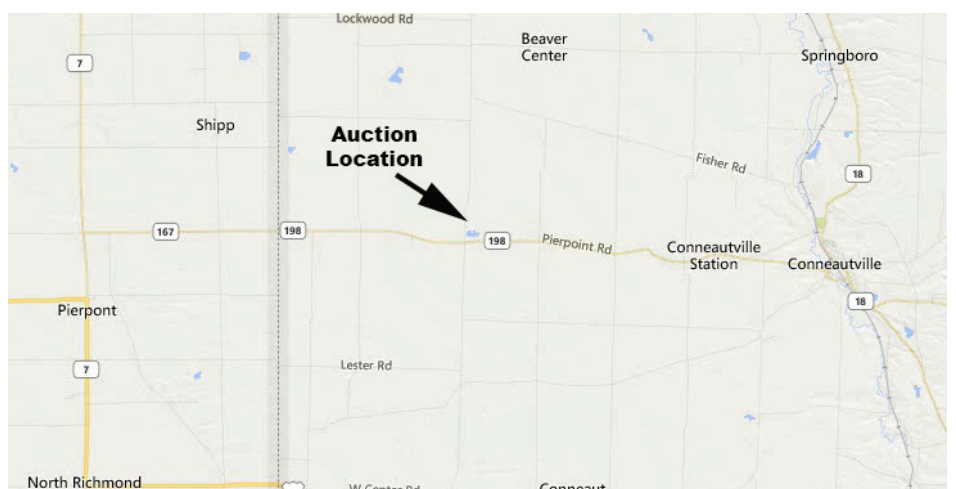

Auctioneer/Realtor®
RUSSELL T. (RUSTY) KIKO, JR.
330.495.0923
rustykiko@kikocompany.com



330.455.9357 • kikoauctions.com

